

Schools Infrastructure NSW Barramurra Public School

Client Hansen Yuncken (SINSW)

Project New High Quality Classroom Model Pack

Timeline 7 months

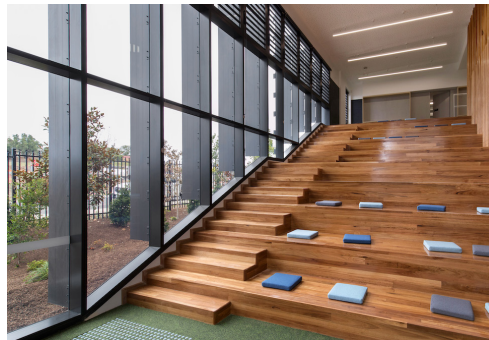

Overview

Fleetwood partnered with Hansen Yuncken to design and construct three new public schools for the Schools Infrastructure New South Wales (SINSW) project using volumetric Design for Manufactured Assembly (DfMA).

Solution

The first of the new 'High Quality Classroom Model Package 2' was Barramurra (Catherine Field Public School, a triple-storey permanent modular facility spanning 4,869m² in new suburb of southwestern Sydney, Barramurra. The solution consisted of 96 modules to create 44 new flexible learning spaces over three storeys. The new facility is now able to cater for 1,000 students from Kindergarten to Year 6.

Benefits

- Successful collaboration was the critical factor. Working closely with D&C Contractor (Hansen Yuncken), SINSW, the architecture firm (PPA) and engineers during the ECI and Construction Phase
- Compliance with EFSG standards
- Volumetric DfMA permanent modular offsite construction achieving NSW Government Design Excellence Standards

